



City of Westminster

Licensing Sub-Committee Report

Item No:	
Date:	13 June 2016
Licensing Ref No:	16/04139/LIPV - Premises Licence Variation
Title of Report:	Hilton London Paddington Hotel 146 Praed Street London W2 1RL
Report of:	Director of Public Protection and Licensing
Wards involved:	Hyde Park
Policy context:	City of Westminster Statement of Licensing Policy
Financial summary:	None
Report Author:	Mr Ola Owojori Senior Licensing Officer
Contact details	Telephone: 020 7641 7830 Email: owojori@westminster.gov.uk

1. Application

1-A Applicant and premises			
Application Type:	Variation of a Premises Licence, Licensing Act 2003		
Application received date:	25 April 2016		
Applicant:	HLT London Manage Limited		
Premises:	Hilton London Paddington Hotel		
Premises address:	Hilton London Paddington 146 Praed Street London W2 1RL	Ward:	Hyde Park
		Cumulative Impact Area:	None
Premises description:	The premises operates as a hotel with restaurant/bar, entertainment and conference/meeting facilities from the ground to the seventh floors		
Variation description:	<p>To delete condition 54 on the premises licence and replace with the following:</p> <p>Access to the Steam Bar between the hours of 09:00 and 21:00 hours be permitted either via the hotel reception or through the secondary entrance at the south west corner of the hotel and which was previously used as an access point to the former casino, and marked with an X on the plan attached on the Premises Licence.</p> <p>After 21:00 on Friday and Saturday only, access to the Steam Bar shall either be via the hotel lobby or via the secondary entrance at the south west corner of the hotel and which was previously used as an access point to the former casino, and is marked with an X on the plan attached to the premises licence.</p> <p>On all other days after 21:00 hours access to the Steam Bar shall only be via the hotel lobby.</p>		
Preliminary Note	The representation from the police has been withdrawn following confirmation from the applicant that public areas at the premises are covered by CCTV cameras and constantly patrolled by the hotel security team.		
Premises licence history:	See Appendix 3		
Applicant submissions:	See Appendix 2		

1-B Conditions being varied	
Condition	Proposed variation
54. Save for Friday and Saturday after 2100 access to the ground floor Steam Bar shall only be via the hotel reception.	Access to the Steam Bar between the hours of 09:00 and 21:00 hours be permitted either via the hotel reception or through the secondary entrance at the

	<p>south west corner of the hotel and which was previously used as an access point to the former casino, and marked with an X on the plan attached on the Premises Licence.</p> <p>After 21:00 on Friday and Saturday only, access to the Steam Bar shall either be via the hotel lobby or via the secondary entrance at the south west corner of the hotel and which was previously used as an access point to the former casino, and is marked with an X on the plan attached to the premises licence.</p> <p>On all other days after 21:00 hours access to the Steam Bar shall only be via the hotel lobby.</p>
--	--

Adult entertainment:	Current position:	Proposed position:
	N/A	N/A

1-C Current and proposed licensable activities, areas and hours
(No variation have been proposed)

Regulated Entertainment

Exhibition of films
Playing of Recorded Music

Indoors	Current Hours		Proposed Hours		Licensable Area	
	Start:	End:	Start:	End:	Current:	Proposed:
Monday	00:00	00:00	No change		Ground to Seventh floors	No change
Tuesday	00:00	00:00	No change		Ground to Seventh floors	No change
Wednesday	00:00	00:00	No change		Ground to Seventh floors	No change
Thursday	00:00	00:00	No change		Ground to Seventh floors	No change
Friday	00:00	00:00	No change		Ground to Seventh floors	No change
Saturday	00:00	00:00	No change		Ground to Seventh floors	No change
Sunday	00:00	00:00	No change		Ground to Seventh floors	No change

Seasonal variations:	Current:	Proposed:
	N/A	N/A

Non-standard timings:	Current:	Proposed:
	N/A	N/A

Performance of live music Performance of Dance						
Indoors	Current Hours		Proposed Hours		Licensable Area	
	Start:	End:	Start:	End:	Current:	Proposed:
Monday	10:00	03:00	No change		Ground to Seventh floors	No change
Tuesday	10:00	03:00	No change		Ground to Seventh floors	No change
Wednesday	10:00	03:00	No change		Ground to Seventh floors	No change
Thursday	10:00	03:00	No change		Ground to Seventh floors	No change
Friday	10:00	03:00	No change		Ground to Seventh floors	No change
Friday (Steam Bar)	10:00	04:00	No change		Ground to Seventh floors	No change
Saturday	10:00	03:00	No change		Ground to Seventh floors	No change
Saturday (Steam Bar)	10:00	04:00	No change		Ground to Seventh floors	No change
Sunday	10:00	03:00	No change		Ground to Seventh floors	No change
Seasonal variations/ Non-standard timings:	Current:				Proposed:	
	From the end of permitted hours on New Year's Eve to 03:00 on 2 January				No change	

Late night refreshment						
			Current :		Proposed:	
			Indoors		No change	
	Current Hours		Proposed Hours		Licensable Area	
	Start:	End:	Start:	End:	Current:	Proposed:
Monday	23:00	05:00	No change		Ground to Seventh floors	No change
Tuesday	23:00	05:00	No change		Ground to Seventh floors	No change
Wednesday	23:00	05:00	No change		Ground to Seventh floors	No change
Thursday	23:00	05:00	No change		Ground to Seventh floors	No change
Friday	23:00	05:00	No change		Ground to Seventh floors	No change
Saturday	23:00	05:00	No change		Ground to Seventh floors	No change
Sunday	23:00	05:00	No change		Ground to Seventh floors	No change
Seasonal variations/ Non-standard timings:	Current:				Proposed:	
	N/A				N/A	

Sale by Retail of Alcohol						
On or off sales			Current :			Proposed:
			On and Off			No change
	Current Hours		Proposed Hours		Licensable Area	
	Start:	End:	Start:	End:	Current:	Proposed:
Mon – Sun Residents	00:00	00:00	No change		Ground to Seventh floors	No change
Monday	10:00	03:00	No change		Ground to Seventh floors	No change
Tuesday	10:00	03:00	No change		Ground to Seventh floors	No change
Wednesday	10:00	03:00	No change		Ground to Seventh floors	No change
Thursday	10:00	03:00	No change		Ground to Seventh floors	No change
Friday	10:00	03:00	No change		Ground to Seventh floors	No change
Friday (Steam Bar)	10:00	03:30	No change		Ground to Seventh floors	No change
Saturday	10:00	03:00	No change		Ground to Seventh floors	No change
Saturday (Steam Bar)	10:00	03:30	No change		Ground to Seventh floors	No change
Sunday	10:00	03:00	No change		Ground to Seventh floors	No change
Seasonal variations/ Non-standard timings:	Current:				Proposed:	
	From the end of permitted hours on New Year's Eve to 03:00 on 2 January				No change	

Hours premises are open to the public						
	Current Hours		Proposed Hours		Premises Area	
	Start:	End:	Start:	End:	Current:	Proposed:
Monday	00:00	00:00	No change		Ground to Seventh floors	No change
Tuesday	00:00	00:00	No change		Ground to Seventh floors	No change
Wednesday	00:00	00:00	No change		Ground to Seventh floors	No change
Thursday	00:00	00:00	No change		Ground to Seventh floors	No change
Friday	00:00	00:00	No change		Ground to Seventh floors	No change
Saturday	00:00	00:00	No change		Ground to Seventh floors	No change
Sunday	00:00	00:00	No change		Ground to Seventh floors	No change
Seasonal variations/ Non-standard timings:	Current:				Proposed:	
	N/A				N/A	

2. Representations

2-A Responsible Authorities	
Responsible Authority:	Environmental Health Consultation Team
Representative:	Sally Thomas
Received:	20 May 2016
<p>I refer to the application for variation of a Premises Licence (15/00765/LIPVM), issued under the Licensing Act 2003.</p> <p>Layout plans have not been submitted, I refer to those on the existing licence.</p> <p>This representation is based on the Operating Schedule and existing plan.</p> <p>The applicant is seeking the following in the ground floor:</p> <ol style="list-style-type: none">1. To delete condition 54 'Save for Friday and Saturday after 2100 access to the ground floor Steam Bar shall only be via the hotel reception.' and replace with 'Access to the Steam Bar between the hours of 0900 and 2100 be permitted either via the hotel reception or through the secondary entrance at the south west corner of the hotel and which was previously used as an access point to the former casino, and marked with an X on the plan attached to the Premises Licence. <p>After 2100 on Friday and Saturday only, access to the Steam Bar shall wither be via the hotel lobby or via the secondary entrance at the south west corner of the hotel and which was previously used as an access point to the former casino, and is marked with an X on the plan attached to the Premises Licence.</p> <p>On all other days after 2100 access to the Steam Bar shall only be via the hotel lobby.'</p> <p>I wish to make the following representations in relation to the above application:</p> <ol style="list-style-type: none">1. The change in access to the bar may cause an increase in Public Nuisance in the area and may impact on Public Safety. <p>The granting of the variation Premises Licence as presented would have the likely effect of causing an increase in Public Nuisance in the area and may impact on Public Safety.</p> <p>Should you wish to discuss the matter further please do not hesitate to contact me.</p>	

2-B Other Person			
Name:		John Zamit	
Address and/or Residents Association:		Chairman SEBRA (South East Bayswater Residents' Association) 2 Claremont Court Queensway LONDON W2 5HX	
Status:	Residents Association	In support or opposed:	Opposed
Received:	22 May 2016		
<p>We object to the application as it may potentially cause amenity and crime issues.</p> <p>I am unable to access all my files at present</p> <p>I have had a very positive conversation with the manager of hotel who explained the proposal</p> <p>We need clarification of hours of secondary entrance to bar and what time it will close each day</p> <p>We also need confirmation on CCTV agreements outside the secondary entrance and what hours/ security guards/doorman will be on duty outside the secondary entrance.</p> <p>I trust taxis/ mini cabs will not drop off / pick up 'customers by secondary entrance as double blipped yellow lines in Praed street just by the junction with Eastbourne Terrace.</p> <p>I am sure agreement can be reached on this application and we will be interested to know the position of Environmental Health and Metropolitan Police and if any individual objectors.</p>			

3. Policy & Guidance

The following policies within the City Of Westminster Statement of Licensing Policy apply:	
Policy HOT1 applies	<p>Subject to the effect on the promotion of the licensing objectives and other relevant policies in this Statement, premises licences for hotels will generally be granted so that:</p> <p>(a) Alcohol is permitted to be sold at any time to people staying in hotel rooms for consumption on the premises.</p> <p>(b) The hours of serving of alcohol to the general public will be subject to conditions limiting the sale of alcohol after a specified time to those attending pre-booked events held at the hotel,</p> <p>(c) The exhibition of film, in the form of recordings or non-broadcast television programmes to be viewed in hotel bedrooms, will generally be permitted.</p>

4. Appendices

Appendix 1	Premises plans
Appendix 2	Applicant supporting documents
Appendix 3	Premises history
Appendix 4	Proposed conditions
Appendix 5	Residential map and list of premises in the vicinity

Report author:	Mr Ola Owojori Senior Licensing Officer
Contact:	Telephone: 020 7641 7830 Email: owojori@westminster.gov.uk

If you have any queries about this report or wish to inspect one of the background papers please contact the report author.

Background Documents – Local Government (Access to Information) Act 1972

1	Licensing Act 2003	N/A
2	City of Westminster Statement of Licensing Policy	7 th January 2016
3	Amended Guidance issued under section 182 of the Licensing Act 2003	March 2015
4	Application Acknowledged	25/4/16
5	Public Notice	25/4/16
6	Application Form	27.4.16
7	Plan	27.4.16
8	Existing Licence	27.4.16
9	Notification of application	27.4.16
10	Applicant correspondence	27.4.16
11	Police representation	17/5/16
12	EH representation	20/5/16
13	Hearing Notification	26/5/16
14	SEBRA representation	31/5/16
15	Withdrawal of Police representation	2/6/16
16		
17		
18		
19		
20		
21		
22		
23		
24		

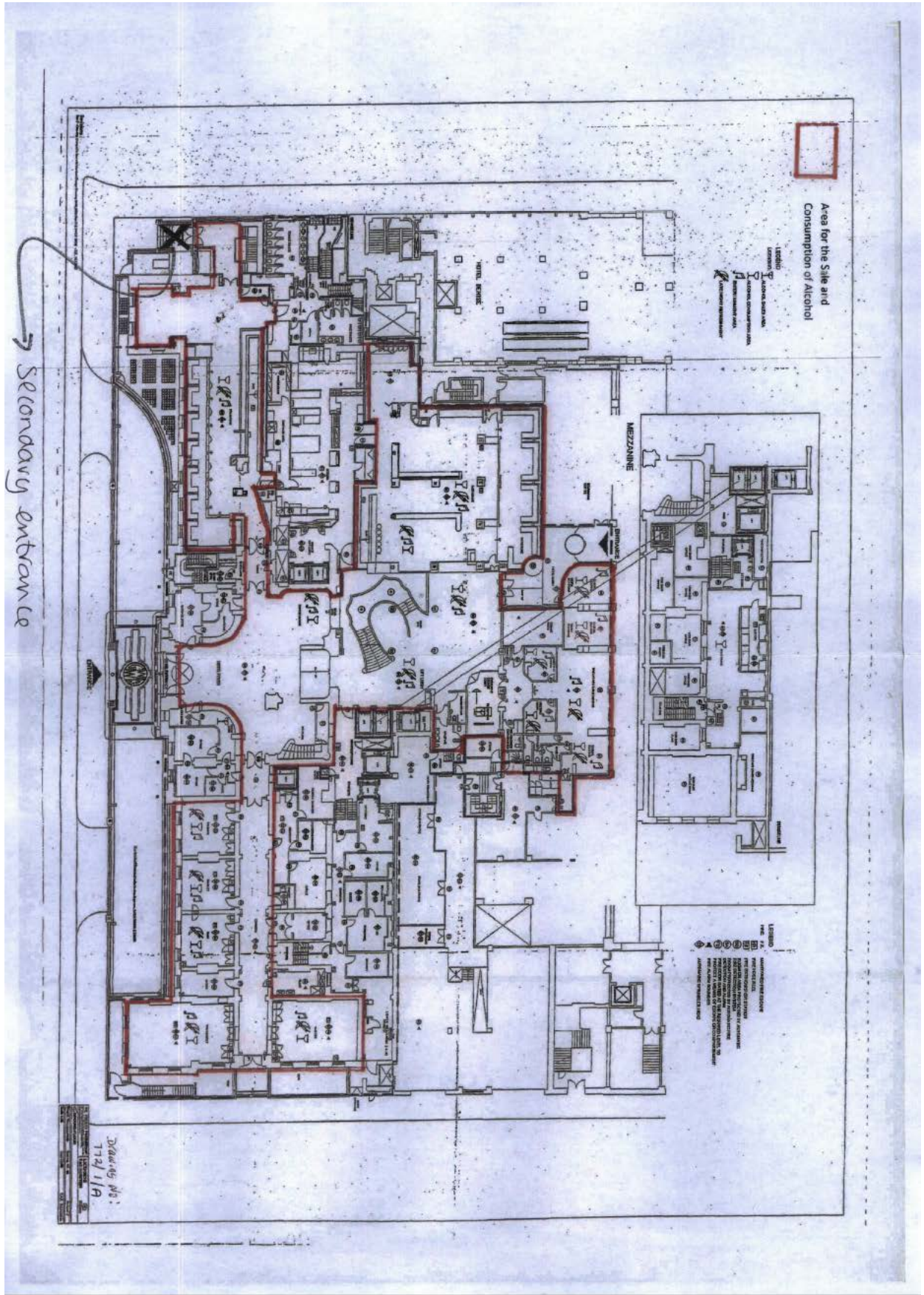

None

Appendix 3

Licence & Appeal History

Application	Details of Application	Date Determined	Decision
New application	Application for a new premises licence	10.8.06	Granted by Licensing Sub Committee
Variation	Variation to increase the terminal hour from 03:00 to 04:00 hours (Extension on Friday and Saturday only in Steam Bar)	10.11.11	Granted by Licensing Sub Committee
Variation	Variation to amend the capacity in the Steam Bar from 180 persons to 230 persons.	10.6.14	Granted under delegated authority
New	New application to replace existing licence Note – one effect of this new application will introduce a separate street entrance to the Steam Bar (currently entrance must be through main hotel lobby on existing licence)	22.1.15	Granted by Licensing Sub Committee
Minor Variation	To amend the works condition which appeared at condition 53 on the schedule of proposed conditions provided to the Licensing Sub - Committee on the 22 January 2015 so that it reads as follows: "That the licence be released and that the use of the new permitted access to the Steam Bar be of no effect until it has been assessed as satisfactory by the Environmental Health Consultation Team and this condition has been removed from the licence".	18.2.15	Granted under delegated authority

There is no appeal history

CONDITIONS CONSISTENT WITH THE OPERATING SCHEDULE AND CONDITIONS PROPOSED BY A PARTY TO THE HEARING

When determining an application for a new premises licence under the provisions of the Licensing Act 2003, the licensing authority must, unless it decides to reject the application, grant the licence subject to the conditions which are indicated as mandatory in this schedule.

At a hearing the licensing authority may, in addition, and having regard to any representations received, grant the licence subject to such conditions which are consistent with the operating schedule submitted by the applicant as part of their application, or alter or omit these conditions, or add any new condition to such extent as the licensing authority considers appropriate for the promotion of the licensing objectives.

This schedule lists those conditions which are consistent with the operating schedule, or proposed as appropriate for the promotion of the licensing objectives by a responsible authority or an interested party as indicated. These conditions have not been submitted by the licensing service but reflect the positions of the applicant, responsible authority or interested party and have not necessarily been agreed

Conditions: On Current Licence -

Mandatory:

1. No supply of alcohol may be made at a time when there is no designated premises supervisor in respect of this licence.
2. No supply of alcohol may be made at a time when the designated premises supervisor does not hold a personal licence or the personal licence is suspended.
3. Every supply of alcohol under this licence must be made or authorised by a person who holds a personal licence.
4.
 - (1) The responsible person must ensure that staff on relevant premises do not carry out, arrange or participate in any irresponsible promotions in relation to the premises.
 - (2) In this paragraph, an irresponsible promotion means any one or more of the following activities, or substantially similar activities, carried on for the purpose of encouraging the sale or supply of alcohol for consumption on the premises—
 - (a) games or other activities which require or encourage, or are designed to require or encourage, individuals to;
 - (i) drink a quantity of alcohol within a time limit (other than to drink alcohol sold or supplied on the premises before the cessation of the

- (i) beer or cider: ½ pint;
 - (ii) gin, rum, vodka or whisky: 25 ml or 35 ml; and
 - (iii) still wine in a glass: 125 ml;
- (b) these measures are displayed in a menu, price list or other printed material which is available to customers on the premises; and
- (c) where a customer does not in relation to a sale of alcohol specify the quantity of alcohol to be sold, the customer is made aware that these measures are available.

A responsible person in relation to a licensed premises means the holder of the premise licence in respect of the premises, the designated premises supervisor (if any) or any individual aged 18 or over who is authorised by either the licence holder or designated premises supervisor. For premises with a club premises certificate, any member or officer of the club present on the premises in a capacity that which enables him to prevent the supply of alcohol.

8(i) A relevant person shall ensure that no alcohol is sold or supplied for consumption on or off the premises for a price which is less than the permitted price.

8(ii) For the purposes of the condition set out in paragraph 8(i) above -

- (a) "duty" is to be construed in accordance with the Alcoholic Liquor Duties Act 1979;
- (b) "permitted price" is the price found by applying the formula -

$$P = D + (D \times V)$$

Where -

- (i) P is the permitted price,
 - (ii) D is the amount of duty chargeable in relation to the alcohol as if the duty were charged on the date of the sale or supply of the alcohol, and
 - (iii) V is the rate of value added tax chargeable in relation to the alcohol as if the value added tax were charged on the date of the sale or supply of the alcohol;
- (c) "relevant person" means, in relation to premises in respect of which there is in force a premises licence -
- (i) the holder of the premises licence,
 - (ii) the designated premises supervisor (if any) in respect of such a licence, or
 - (iii) the personal licence holder who makes or authorises a supply of alcohol under such a licence;
- (d) "relevant person" means, in relation to premises in respect of which there is in force a club premises certificate, any member or officer of the club

present on the premises in a capacity which enables the member or officer to prevent the supply in question; and

(e) "value added tax" means value added tax charged in accordance with the Value Added Tax Act 1994.

8(iii). Where the permitted price given by Paragraph 8(ii)(b) above would (apart from this paragraph) not be a whole number of pennies, the price given by that sub-paragraph shall be taken to be the price actually given by that sub-paragraph rounded up to the nearest penny.

8(iv). (1) Sub-paragraph 8(iv)(2) below applies where the permitted price given by Paragraph 8(ii)(b) above on a day ("the first day") would be different from the permitted price on the next day ("the second day") as a result of a change to the rate of duty or value added tax.

(2) The permitted price which would apply on the first day applies to sales or supplies of alcohol which take place before the expiry of the period of 14 days beginning on the second day.

9. Admission of children to the premises must be restricted in accordance with the film classification recommended by the British Board of Film Classification or recommended by this licensing authority as appropriate.

10. All persons guarding premises against unauthorised access or occupation or against outbreaks of disorder or against damage (door supervisors) must be licensed by the Security Industry Authority.

Annex 2 – Conditions consistent with the operating Schedule

None

Annex 3 – Conditions attached after a hearing by the licensing authority

11. Subject to Condition (15) below, all door staff engaged at Steam Bar whether inside the bar or outside shall wear fluorescent arm bands displaying their SIA badges.

12. On Friday and Saturday nights a minimum of 4 SIA licensed door supervisors shall be on duty at the Steam Bar from 2100 to close of business.

13. On Friday and Saturday nights the Steam Bar must employ 1 female SIA door woman from 2100 to close of business.

14. In the event that a serious assault is committed on the premises (or appears to have been committed) the management will immediately ensure that:

(a) The Police (and where appropriate, the London Ambulance Service) are called without delay;

(b) All measures that are reasonably practicable are taken to apprehend any suspects pending the arrival of the Police;

(c) The crime scene is preserved so as to enable a full forensic investigation to be carried out by the Police; and

- (d) Such other measures are taken (as appropriate) to fully protect the safety of all persons present on the premises.
15. From the end of licensable activities up until 30 minutes after the end of licensable activities in the Steam Bar on a Friday and Saturday night, the door staff employed outside the premises shall wear high vis jackets to ensure safe and crime free dispersal of customers from the premises.
 16. The premises shall install and maintain a comprehensive CCTV system as per the minimum requirements of the Westminster Police Licensing Team. All entry and exit points will be covered enabling frontal identification of every person entering in any light condition. The CCTV system shall continually record whilst the premises is open for licensable activities and during all times when customers remain on the premises. All recordings shall be stored for a minimum period of 31 days with date and time stamping. Viewing of recordings shall be made available immediately upon the request of Police or authorised officer throughout the preceding 31 day period.
 17. A staff member from the premises who is conversant with the operation of the CCTV system shall be on the premises at all times when the premises is open to the public. This staff member shall be able to show Police recent data or footage with the absolute minimum of delay when requested.
 18. A Challenge 25 proof of age scheme shall be operated at the premises where the only acceptable forms of identification are recognised photographic identification cards, such as a driving licence, passport or proof of age card with the PASS Hologram.
 19. The number of persons accommodated at any one time (excluding staff) shall not exceed the following:
 - a) Ground Floor:
 - Steam Bar: 180 (Sunday to Thursday)
 - Steam Bar: 230 (Friday to Saturday)
 - Restaurant: 150
 - Executive Lounge: 100
 - Maclver Function Room: 40
 - Thunderbolt Function Room: 50
 - Maine Function Room: 20
 - Tangley Function Room: 20
 - Talisman Function Room: 20
 - b) First Floor:
 - Hobart Function Room: 20
 - Campanula Function Room: 25
 - Hurricane Function Room: 15
 - Kingfisher Function Room: 25
 - Redstar Function Room: 40
 - Comet Function Room: 20
 - Hotspur Function Room: 10
 - King George Function Room: 25
 - Great Western 1 and Great Western 2 Function Rooms: 400

c) Second Floor:
Somerset Function Room: 12

d) Fourth Floor
Cornwall Function Room: 20

e) Fifth Floor
Arlington Function Room: 20

20. Substantial food will be available throughout the permitted hours.
21. The supply of alcohol and provision of regulated entertainment in the Function and Meeting Rooms shall be restricted to pre-booked functions only.
22. The supply of alcohol in the Restaurant after 23:00 hours until 03:00 hours shall be ancillary to table meals or to persons who are:
 - (i) Residents of the hotel;
 - (ii) Guests of residents of the hotel;
 - (iii) Persons attending a pre-booked function at the hotel;
 - (iv) Bona fide guests of the proprietor;
 - (v) Artistes or persons employed at the premises.
23. The supply of Alcohol in the Steam Bar after 23:00 hours shall be ancillary to music and/ or dancing and substantial refreshment.
24. For any persons admitted to the Steam Bar after 23:00 hours, the supply of alcohol shall only take place if they fall into one of the following categories, namely:
 - a) persons who have paid a minimum admission fee of £5 Sunday to Thursday and £7 Friday and Saturday, such sum not to be credited against consumables; or
 - b) persons attending a pre-booked private function at the premises; or
 - c) artistes or persons employed at the premises; or
 - d) bona fide guests of the proprietor; or
 - e) persons who are taking or have taken a table meal within the hotel; or
 - f) persons residing at the hotel and their bona fide guests.
25. With the exception of residents and their bona fide guests, all alcohol must be consumed within 30 minutes after the end of permitted hours.
26. Persons under 16 shall not be permitted in the bar areas unless accompanied by an adult.
27. With the exception within hotel bedrooms there shall be no striptease, no nudity and all persons shall be decently attired at all times in all parts of the premises.
28. The approved arrangements at the premises, including means of escape provisions, emergency warning equipment, the electrical installation and

mechanical equipment, shall at all material times be maintained in good condition and full working order.

29. The means of escape provided for the premises shall be maintained unobstructed, free of trip hazards, be immediately available and clearly identified in accordance with the plans provided.
30. All emergency exit doors shall be available at all material times without the use of a key, code, card or similar means.
31. All emergency doors shall be maintained effectively self closing and not held open other than by an approved device.
32. The edges of the treads of steps and stairways shall be maintained so as to be conspicuous.
33. Curtains and hangings shall be arranged so as not to obstruct emergency safety signs or emergency equipment.
34. All fabrics, curtains, drapes and similar features including materials used in finishing and furnishing shall be either non-combustible or be durably or inherently flame-retarded fabric. Any fabrics used in escape routes (other than foyers), entertainment areas or function rooms, shall be non-combustible.
35. The certificates listed below shall be submitted to the Licensing Authority upon written request.
 - a. Any permanent or temporary emergency lighting battery or system;
 - b. Any permanent or temporary electrical installation;
 - c. Any permanent or temporary emergency warning system.
36. Flashing or particularly bright lights on or outside the premises shall not cause a nuisance to nearby properties, save insofar as they are necessary for the prevention of crime.
37. The provision of Regulated Entertainment shall be ancillary to the main use of the premises as a hotel.
38. Food and non-alcoholic drinks including drinking water shall be available in all parts of the premises where alcohol is available.
39. On Sunday to Thursdays if there is a pre-booked party of 100 persons or more at the Steam Bar then an SIA registered door supervisor shall be present at the hotel lobby entrance to the Steam Bar from 21:00 until all patrons have left the said Steam Bar.
40. In relation to licensable activities or the provision of facilities to enable licensable activities to take place no noise shall emanate from the premises nor vibration be transmitted through the structure of the premises which gives rise to a nuisance.

41. Entrance to the Executive Lounge shall be restricted to those guests who are residing in an Executive room at the premises, or to those people who pay an entry fee.
42. The Executive Lounge shall be supervised at all times by a dedicated member of staff.
43. All 'off' sales are to be in sealed containers and for consumption off the premises.
44. To permit Regulated Entertainment consisting of Live Music, Performance of Dance, Anything of a similar description to Live Music, Recorded Music or Performance of Dance, on New Year's Eve from 10:00 hours until 03.00 on 2 January.
45. The premises may remain open for the sale of alcohol and the provision of late night refreshment from the terminal hour for those activities on New Year's Eve through to the commencement time for those activities on New Year's Day.
46. An incident log shall be kept at the premises, and made available on request to an authorised officer of the City Council or the Police, which will record the Following.
 - (a) all crimes reported to the venue
 - (b) any complaints received regarding crime and disorder
 - (c) any incidents of disorder
 - (d) any faults in the CCTV system
 - (e) any refusal of the sale of alcohol
 - (f) any visit by a relevant authority or emergency service.
47. There shall be no admittance after 02:30 hours to the Steam Bar.
48. There shall be no re-admittance after 02:30 hours to the Steam Bar except for those wishing to smoke.
49. The licence holder shall ensure that any queue to enter the premises which forms outside the premises is orderly and supervised by door staff so as to ensure that there is no public nuisance or obstruction to the public highway.
50. The premises licence holder shall ensure that any patrons smoking outside the premises do so in an orderly manner and are supervised by staff so as to ensure that there is no public nuisance or obstruction of the public highway.
51. No advertisements of any kind (including placard, poster, sticker, flyer, picture, letter, sign or other mark) that advertises or promotes the Steam Bar, its premises, or any of its events, facilities, goods or services shall be inscribed or affixed upon the surface of the highway, or upon any building, structure, works, street furniture, tree, or any other property, or be distributed to the public.
52. Any special effects or mechanical installations shall be arranged and stored so as to minimise any risk to the safety of those using the premises. The following

special effects will only be used on 10 days prior notice being given to the Licensing Authority where consent has not previously been given.

- dry ice and cryogenic fog;
- smoke machines and fog generators;
- pyrotechnics including fireworks;
- firearms;
- lasers;
- explosives and highly flammable substances;
- real flame;
- strobe lighting.

53. There shall be no off sales of alcohol in the Steam Bar.
54. Save for Friday and Saturday after 2100 access to the ground floor Steam Bar shall only be via the hotel reception. **(Proposed to be varied)**
55. The provision of licensable activity in the Steam Bar shall be ancillary to the use of the premises as a hotel.
56. Patrons temporarily leaving and then re-entering the premises, e.g. to smoke, shall not be permitted to take drinks or glass containers with them.
57. Patrons permitted to temporarily leave and then re-enter the premises e.g. to smoke, shall be limited to 8 persons at any one time.

Conditions proposed by the applicant

58. Access to the Steam Bar between the hours of 09:00 and 21:00 hours be permitted either via the hotel reception or through the secondary entrance at the south west corner of the hotel and which was previously used as an access point to the former casino, and marked with an X on the plan attached on the Premises Licence.
59. After 21:00 on Friday and Saturday only, access to the Steam Bar shall either be via the hotel lobby or via the secondary entrance at the south west corner of the hotel and which was previously used as an access point to the former casino, and is marked with an X on the plan attached to the premises licence.
60. On all other days after 21:00 hours access to the Steam Bar shall only be via the hotel lobby.

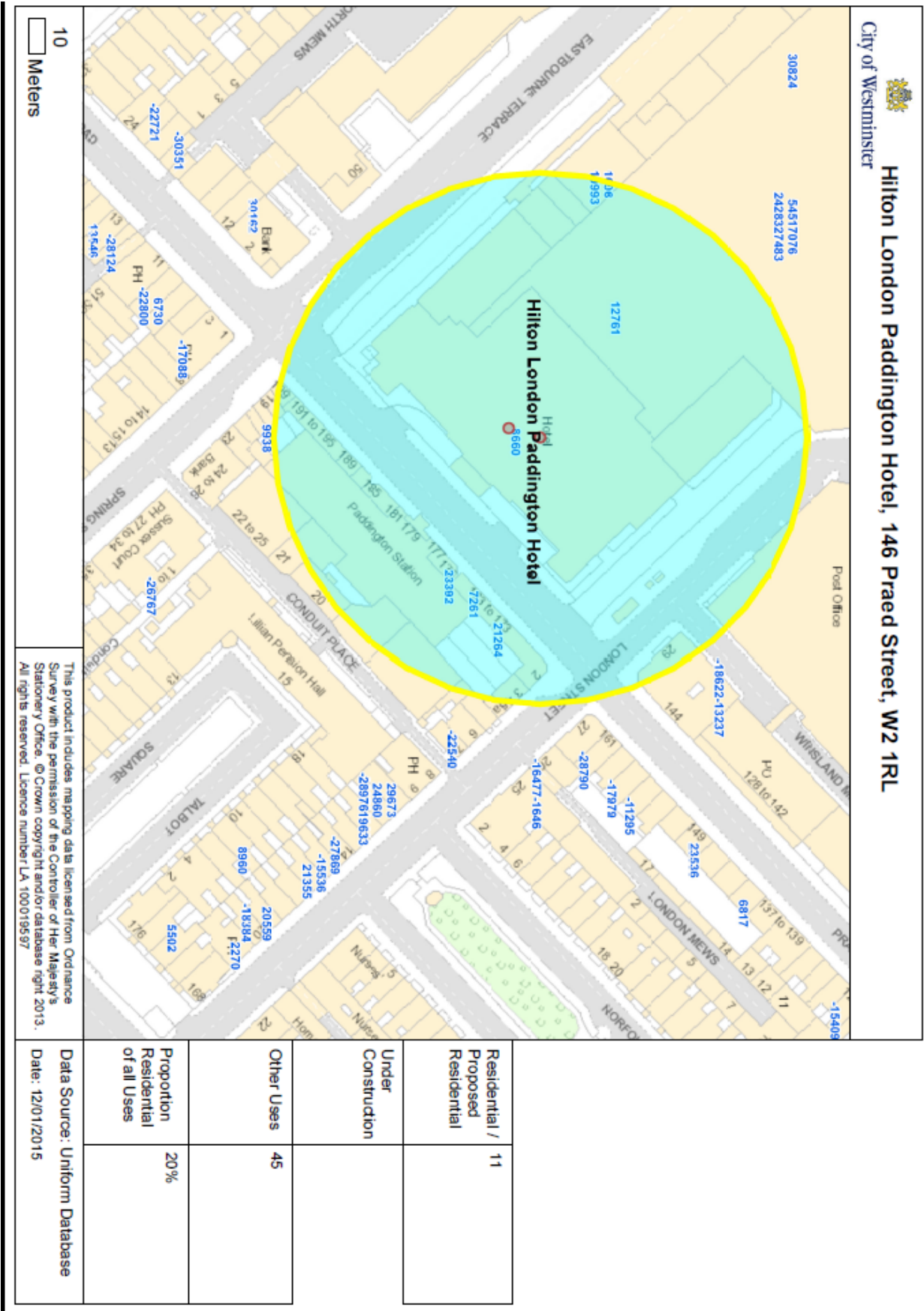

City of Westminster
Hilton London Paddington Hotel, 146 Praed Street, W2 1RL

This product includes mapping data licensed from Ordnance Survey with the permission of the Controller of Her Majesty's Stationery Office. © Crown copyright and/or database right 2013. All rights reserved. Licence number LA 100019597

Residential / Proposed Residential	11
Under Construction	
Other Uses	45
Proportion Residential of all Uses	20%
Data Source: Uniform Database Date: 12/01/2015	

Premises within 75 metres of: Hilton London Paddington Hotel, 146 Praed Street, W2 1RL

p / n	Name of Premises	Premises Address	Opening Hours
23392	Flames	175 Praed Street London W2 1RH	Monday to Sunday 10:00 - 00:00
7261	Aberdeen Steak House	163-167 Praed Street London W2 1RH	Monday to Saturday 10:00 - 01:00 Sunday 10:00 - 00:00 Sundays before Bank Holidays 10:00 - 01:00
8660	Hilton London Paddington Hotel	Hilton London Paddington 146 Praed Street W2 1RL	Monday to Sunday 00:00 - 00:00
21264	Budgens	171-173 Praed Street London W2 1RH	Monday to Saturday 08:00 - 05:00 Sunday 10:00 - 05:00
12761	Burger King/Caffe Ritazza	Platform 7 And 8 Unit 18 Paddington Station Praed Street W2 1RH	Monday to Sunday 00:00 - 00:00